

Contents



Transportation & Venue Guide



Construction Guide & Safety Compliance



BITEC Online Order

From
Express way

ทางออก
EXIT
17B To Samut Prakan

Use BITEC Entrance 3

ทางออก
EXIT
17C To Chon Buri

Use BITEC Entrance 1



	BTS Skytrain Bangna station Exit 1 , A short walk to the Skywalk bridge leading direct to BITEC
	Public Buses Entrance 1 Travel by bus No. 38, 46, 46A, 48, 132, 139, 180 from Debaratna Rd. Entrance 3 Travel by bus No. 2, 23, 45, 102, 116, 142, 507, 508 from Sukhumvit Rd.
	Mini Vans Pick up & drop off at Bangna Intersection (100 m. from BITEC) to Bangkok Southern Bus Terminal, Bangkok Bus Terminal (Chatuchak), Bangkok Railway Station (Hua Lamphong), Rangsit, Silom, Rama 2
	Exit the Expressway For Entrance 1 - Exit the Expressway to Debaratna Rd. - Keep left, enter service road - Use BITEC U-turn
	Exit the Expressway For Entrance 3 - Exit the Expressway to Samut Prakan (Sukhumvit) - Keep left, to BITEC

3rd FLOOR FOOD & BEVERAGE ZONE

FOOD & BEVERAGE

2nd FLOOR BHIRAJ CONVENTION CENTRE ZONE

CONVENTION HALLS
MEETING ROOMS

G FLOOR EVENT ZONE

EVENT HALLS
FOOD & BEVERAGE

BASEMENT 1 EVENT ZONE

Handicap Parking
811-815/811-816
AIS Serenade Parking
916-920/916-927
Mother Expectant & Elderly Parking
916-927
EV Charger Parking
808-810



FLOOR PLAN BHIRAJ HALL, SILK, NILE, AMBER

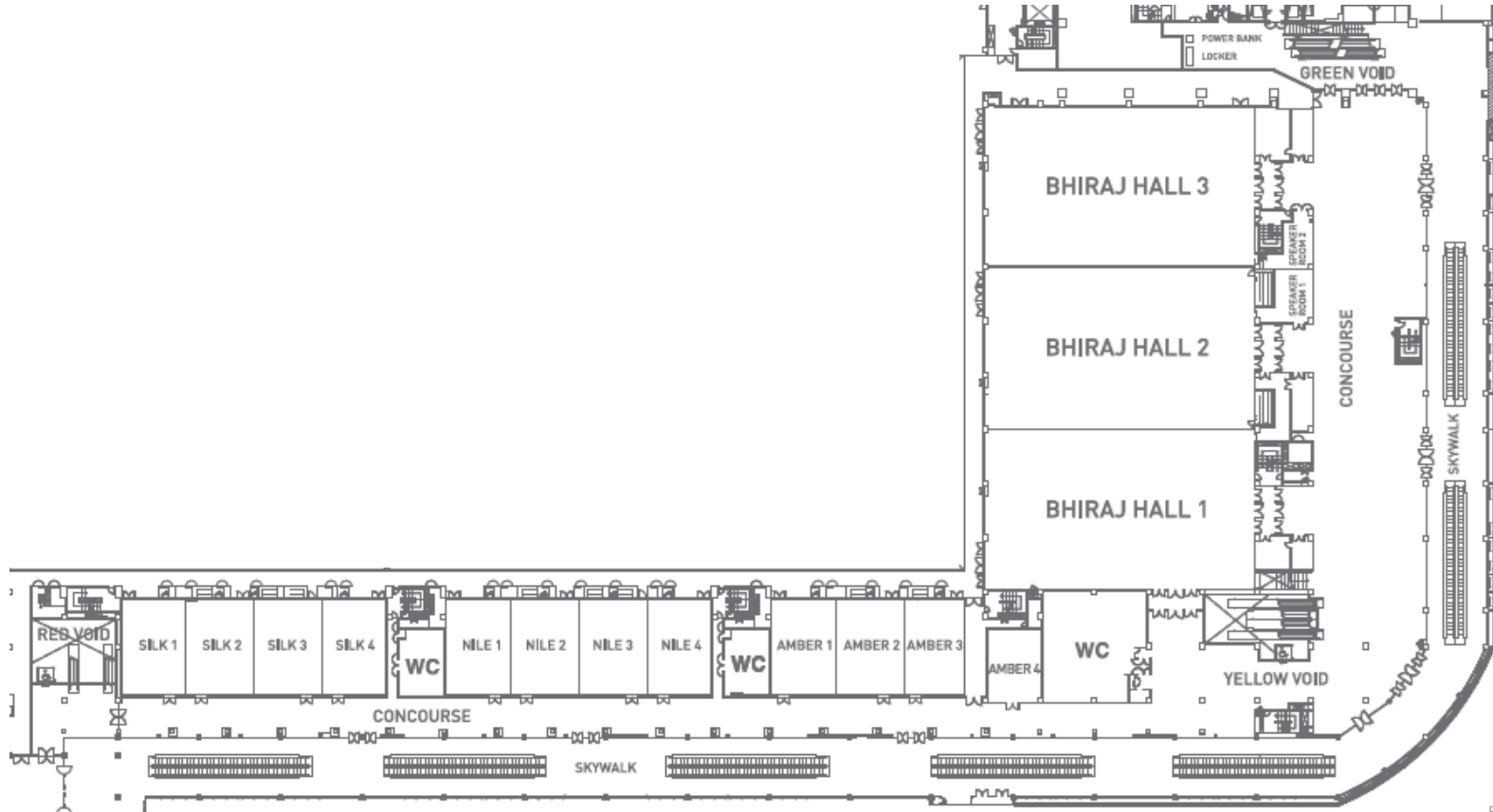

FLOOR PLAN GRAND HALL & MEETING ROOM 210-225

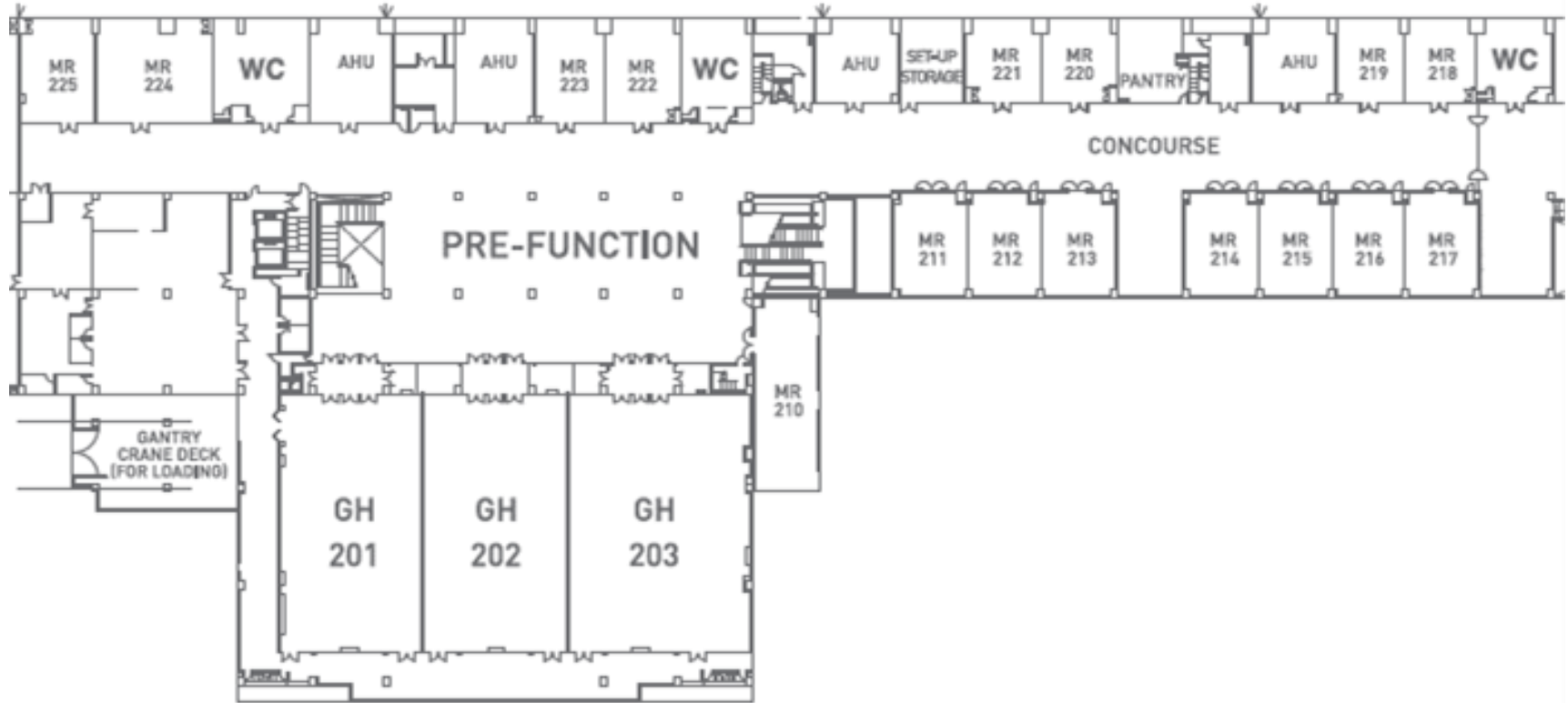

CONVENIENCE STORES



SAMA FOODTORY



PARKING

- Handicap Parking
R11-R15/Q11-Q16
- AIS Serenade Parking
016-022/N16-N22
- Mother Expectant & Elderly Parking
Q16-Q22
- EV Charger Parking
R08-R10

VENUE GUIDE B1

PARKING

- Handicap Parking
S28-Q28/S29-Q29/S30-Q30/S31-Q31/S32-Q32
- AIS Serenade Parking
P29-J29/P30-J30

PARKING

- Handicap Parking
P54-M54/P55-M55/N56-M56
N57-L57/Q58-M58



Car Park



Restroom



Escalator



Food & Beverage



Elevator



ATM



Construction Guide & Safety Compliance





**CONSTRUCTION &
SAFETY CONCERN**



LOADING
RESTRICTION



TRAFFIC
ROUTING



PARKING
REGULATION

- All decorations or constructions must be semi-finished structures.
- The height of the standard booth and special booth on the 2nd floor (GRAND HALL, BHIRAJ HALL) must be at most 3.5 meters. The meeting room must be 2.5 meters, and the Concourse must be 3 meters.



- The floor load for the 2nd floor is 200 kg./sq.m. For equipment, products, or machines to be exhibited, weight must not exceed 200 kg./sq.m.
- The exhibitor must submit the machine perspective with an engineer (Professional Engineer/Associate Engineer) and is required to submit it to the Official Freight Forwarder of the organizer for approval at least 30 days before the move-in period.



Floor Loading and Building Structure

Location	Hanging Point Kg./Point	Floor Load Kg. / Sqm.
BHIRAJ Hall 1 - 3	200	200
Silk 1-4	x	200
Nile 1-4	x	200
Amber 1-4	x	200
Grand Hall 1-3	200	200
Meeting Room 210 - 225	x	200
Concourse 2 nd floor	x	200

Remark : Details of hanging equipment and products on display must be submitted to customer service staff for review and approval always.

- Rigging Point, the Main beam can support not exceed 200 kg. / point and the whole main shaft can support notes exceeding 2,000 kilograms. / beam and Sub beam can help not exceed 100 kg. / point and fundamental sub-beam can keep messages exceeding 1,000 kilograms. / beam

- Working on high ground, the Contractor must have a safety harness helmet and lanyard. Please inform the organizer and exchange cards with staff in the security room (behind the building) before accessing the high-ground



- For lighting and speakers truss, the Contractor or Exhibitor must inform the truss design rigging plot of the total weight of hanging all equipment and is required to submit to the organizer for further approval at least 14 days before move-in.

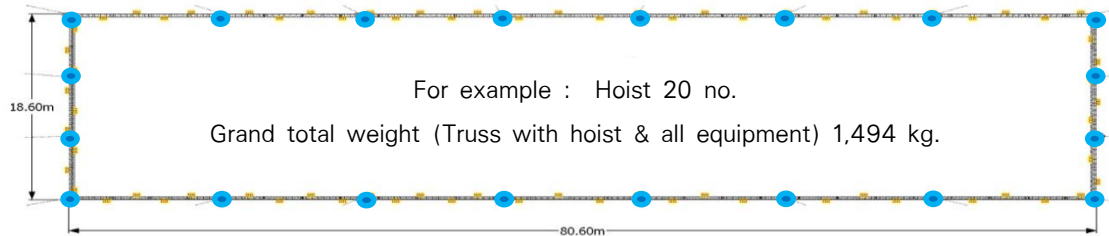

- Truss with construction, Contractor, or Exhibitor must submit the perspective, including rigging plot and total weight of hanging equipment, with an engineer (Professional Engineer/Associate Engineer) and required to submit to the organizer for further approval at least 14 days before move-in.

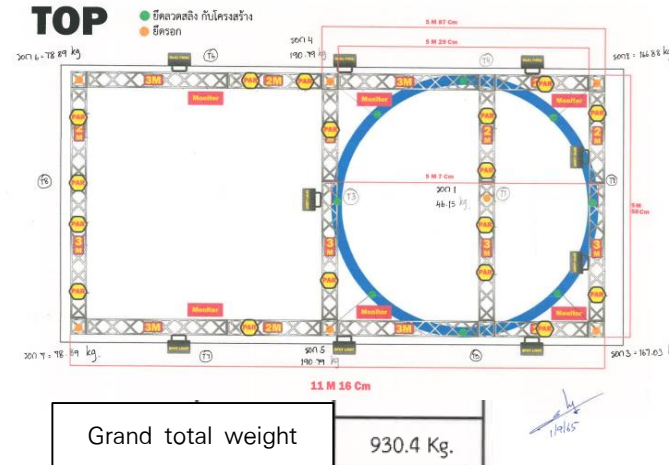

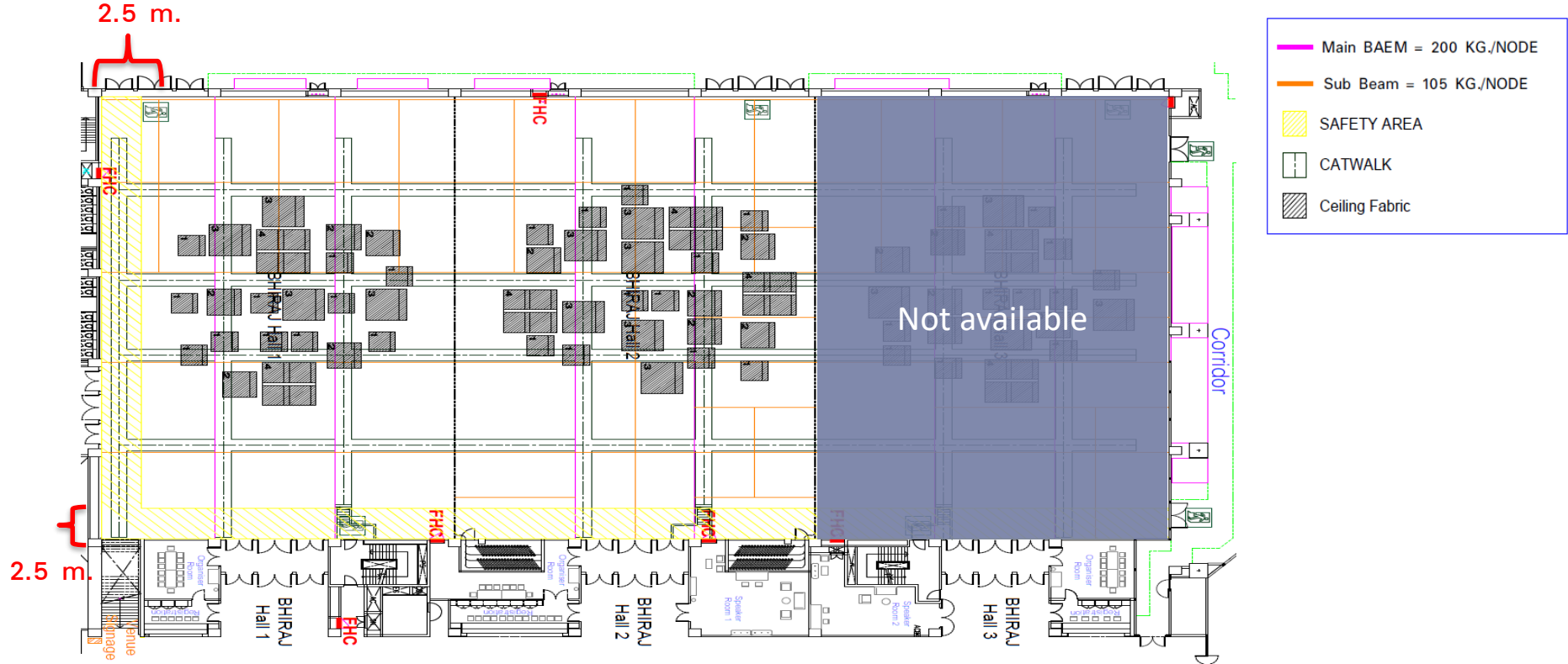

- All construction must be supported by carpet to Protect the floor.
- Not allowed glue or unaccepted adhesive tape is to be used in laying the carpet or any other materials on the Centre's floor. Only residue-resistant tape is allowed.
- Adhesive tape used to decorate the floor or carpet must be thick carpet tape.



- Do not obstruct or block the fire exit, entrance area, aisle, electrical control panel, fire hose cabinet, and fire alarm.

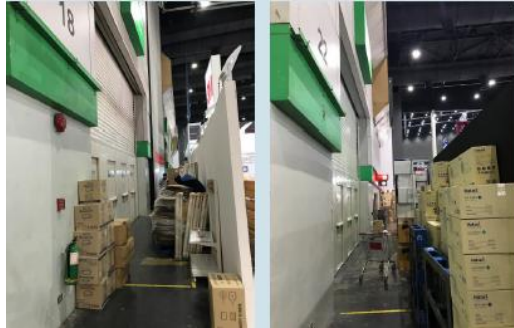

- Do not place boxes and other stock behind the gap between booth and hall partition. For safety reasons**



- Electric sewing in the event hall is prohibited; only handsaw are afforded and must be covered by a floor covering for scrap material.



- The painting, colour-mixed tinner and spray are prohibited. A sander machine with a vacuum tube is required for sandpaper to avoid the smell of colour and dust.



sander machine with vacuum tube

- Trash and garbage from construction or demonstrated during the show. The exhibitor or contractor must take care and remove all trash, garbage or any left over materials out of the BITEC area.



- Do not allow to bring in the flammable before approval from BITEC.



- The Helium, Argon, Nitrogen, and Carbon Dioxide permission are required to be brought in and must be locked with a stable rack. The fire extinguisher is nearby for safety reasons.

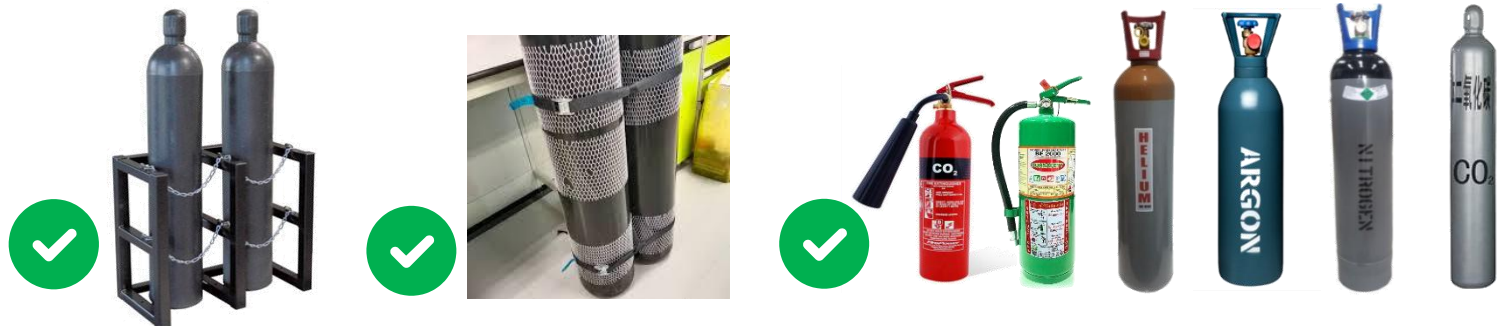

- Do not allow cleaning up all equipment and throwing out hazardous liquid in a toilet because hazardous liquid must be correctly termed via the treatment tank before being thrown out. The dangerous liquid in the utility system may be harmful, including bringing water from the toilet for the exhibit.



- Do not allow the installation of the high-pressure air compressor in the exhibit area. If the air compressor system is installed, the exhibitor or contractor must order from the official contractor.

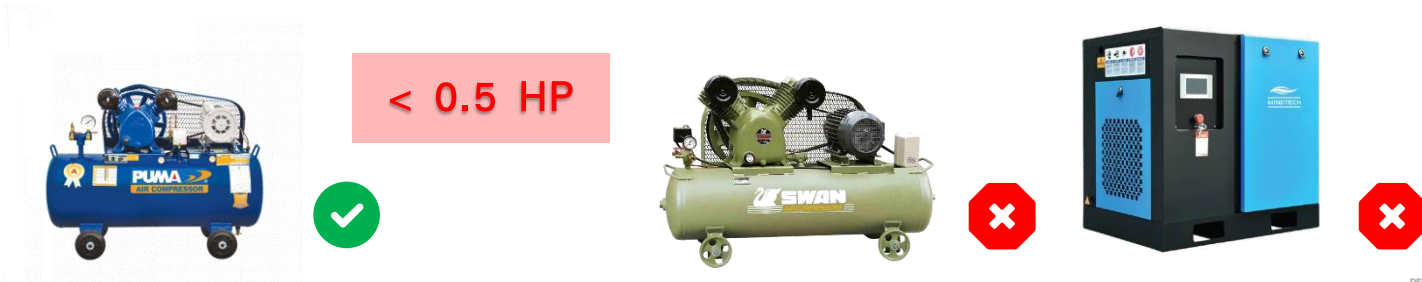

- Do not allow to convert electrical system without power distributor. In case Improper or hazardous electrical installations must be fixed immediately.



- Electric wiring must have clearly signal.
- Do not use extension cord. In case of overload





- Balloons, inflatable tube, and gate decorations should be installed properly and must not affect the nearby booth. Allowed helium gas must fill up before being brought into the event hall and submit the information to the organiser for approval at least 14 days before move-in.

- In an automobile, the supply must be at most 1/8 of the fuel tank and remove all cables, batteries and tape properly. Electrical system wiring for exhibit vehicles must comply with safety standards.



- Requires for Installation overtime: Contractors or Exhibitors must inform the organizer before 20.00 hrs for further preparation and coordination. The overtime rate will be calculated after move-in time.

*These prices do not include electric power.

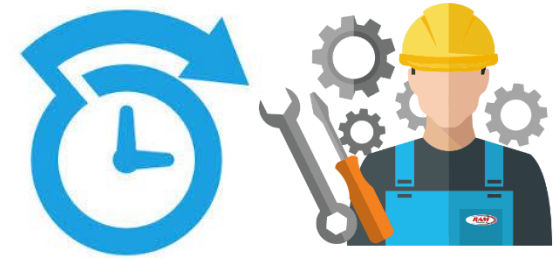

- Utilities will be "turn off" after the event period. (Unless the official contractor has notified BITEC that you have ordered extended utility service or power socket for 24 hours.) BITEC is not responsible if your equipment or products are damaged after the system shutdown.



- Children are not allowed to enter the event area during the move-in and move-out period.
- Animals or Pets are not allowed to enter the event area during the move-in and move-out period.
- Smoking is not allowed indoors and only allowed in designated areas.
- Drinking is strictly prohibited during the move-in and move-out period.
- Slippers are not permitted in the event area during the move-in and move-out period.





CONSTRUCTION &
SAFETY CONCERN



LOADING
RESTRICTION



TRAFFIC
ROUTING



PARKING
REGULATION

LOCATION OF LIFTS FOR LOADING

Receiving Loading Point
Large equipment transport
elevator



Gantry lift size 3x6x3 m.
(Width x Length x High)

Receiving Loading Point
Equipment transport
elevator No. 2

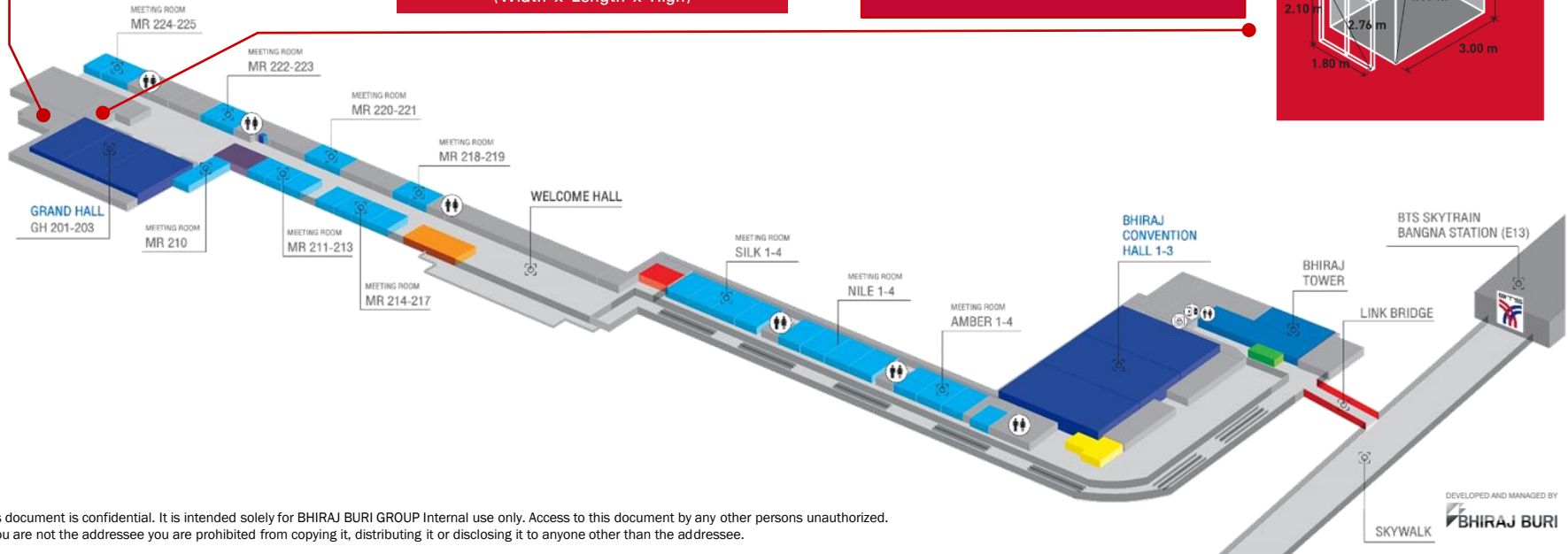
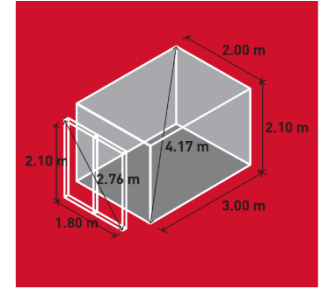

Requirements for using Gantry Lift



Dimension of gantry lift 3x6x3 m. (Width x Length x High)

GANTRY LIFT

- All rights reserved, only in cases where the structure, size and weight exceed what an average lift can support.
- Can bear weight not more than 5,000 Kg.
- The time allowed for use is 5-7 am and time that does not affect other events that are being exhibited
- The application form must be submitted 7 days in advance.
- Inquire for additional terms and conditions of use from Customer service in charge.

LOCATION OF LIFTS FOR LOADING

Welcome Hall Loading Point
Equipment transport elevator
No. 3

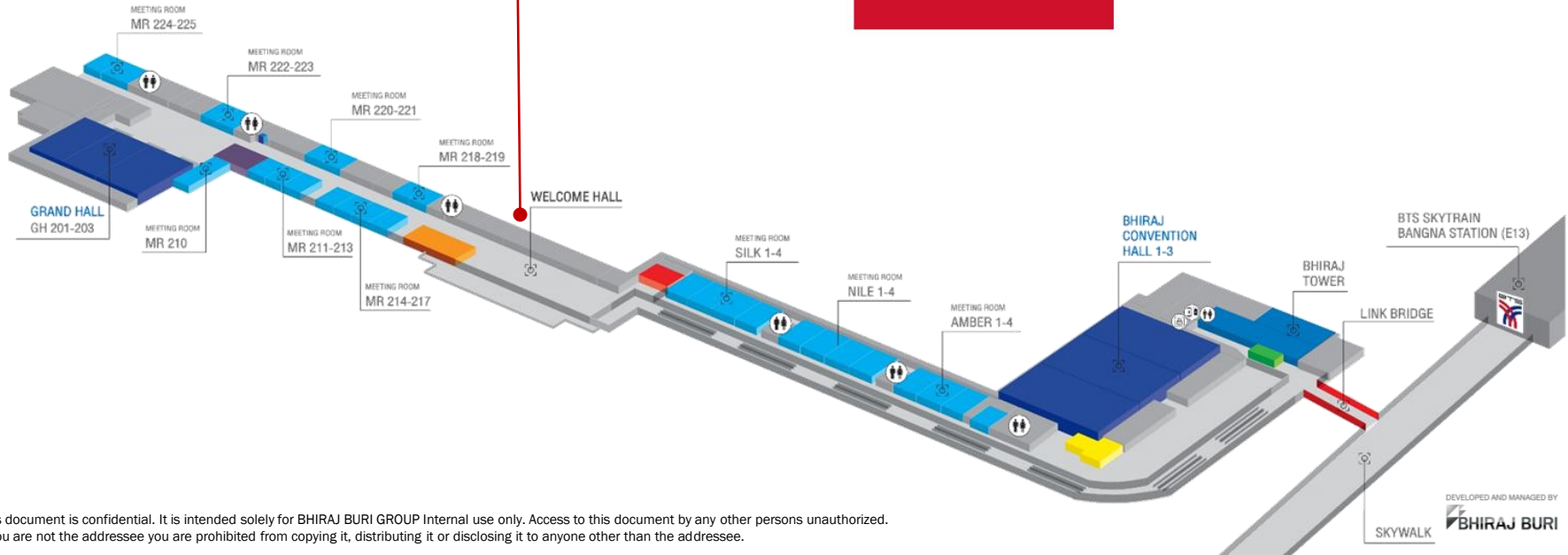
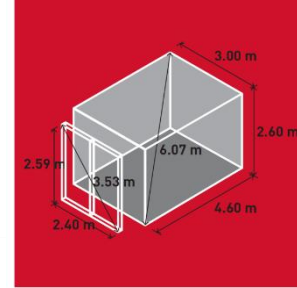

ROUTES GUIDE to Welcome Hall Loading (B1 Floor)

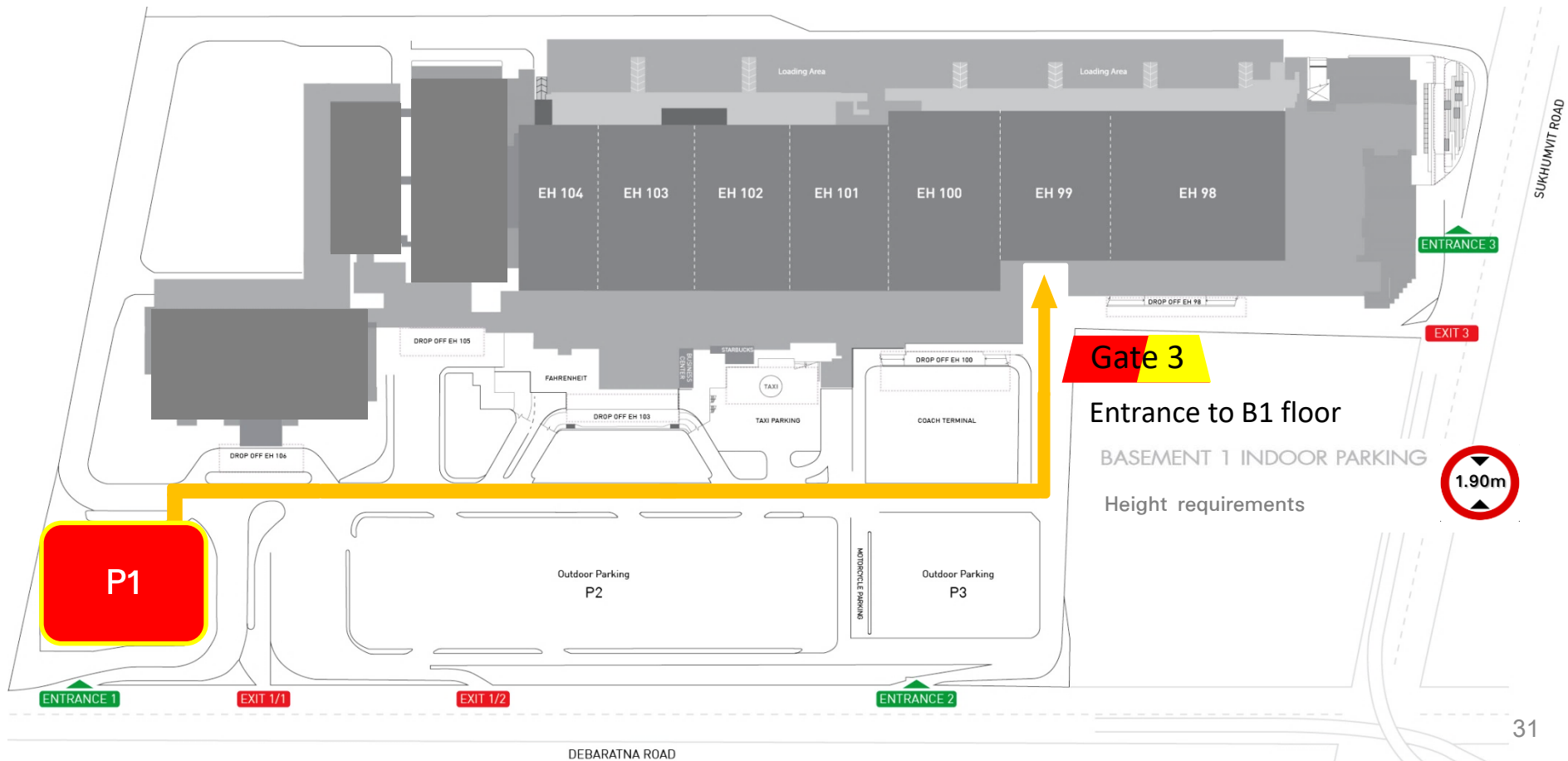

ROUTES GUIDE to Welcome Hall Loading (B1 Floor)

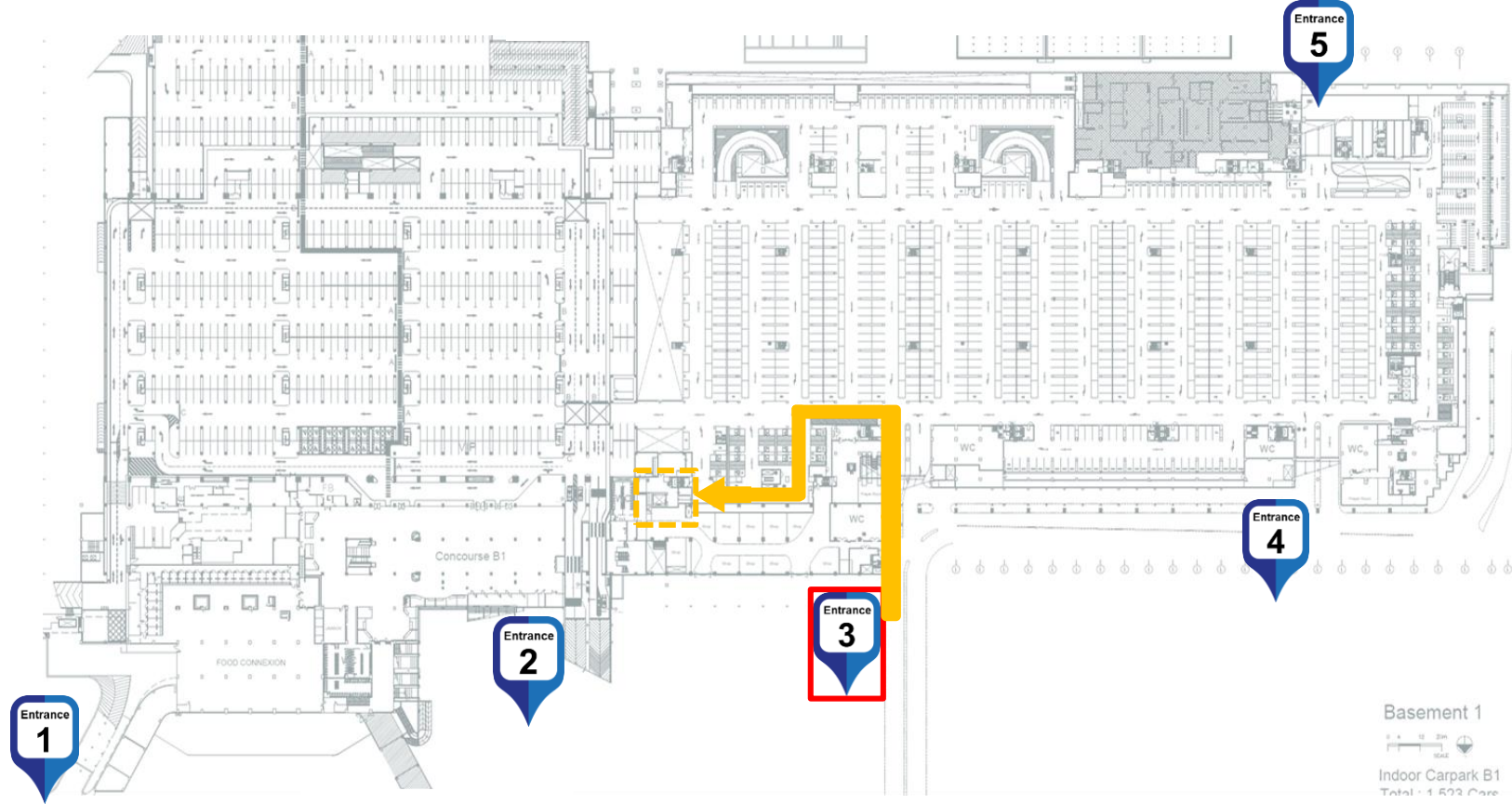

LOCATION OF LIFTS FOR LOADING

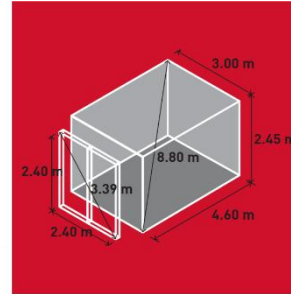

EH98 loading point
Food elevator no. 4
Equipment transport elevator No. 6

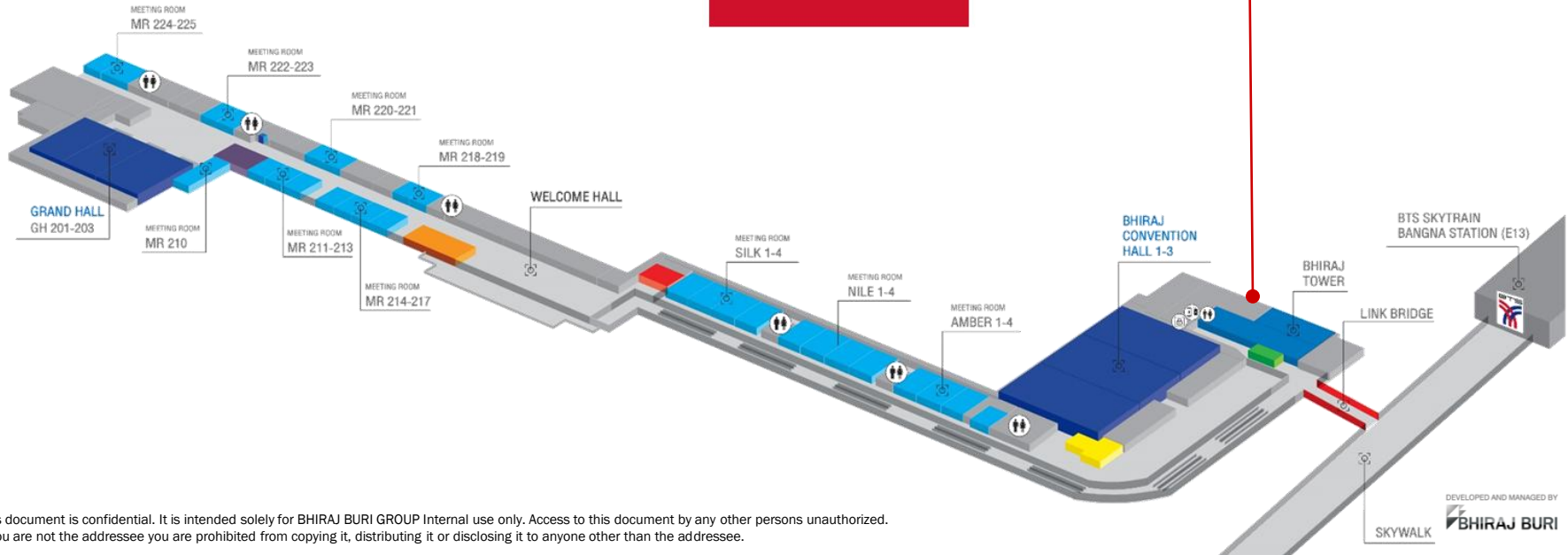

DIMENSION FOR LOADING DOOR BHIRAJ HALL

Size 2.9x2 m.



Size 2.3x3 m.



Size 2.4x4.6x2.4 m.
Can bear the weight of 5,000 Kg.

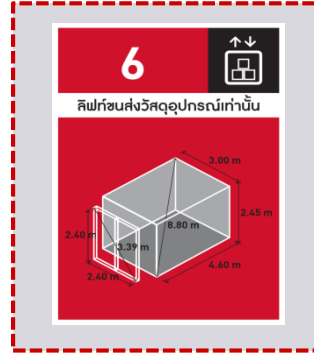

Size 2x2.5 m.

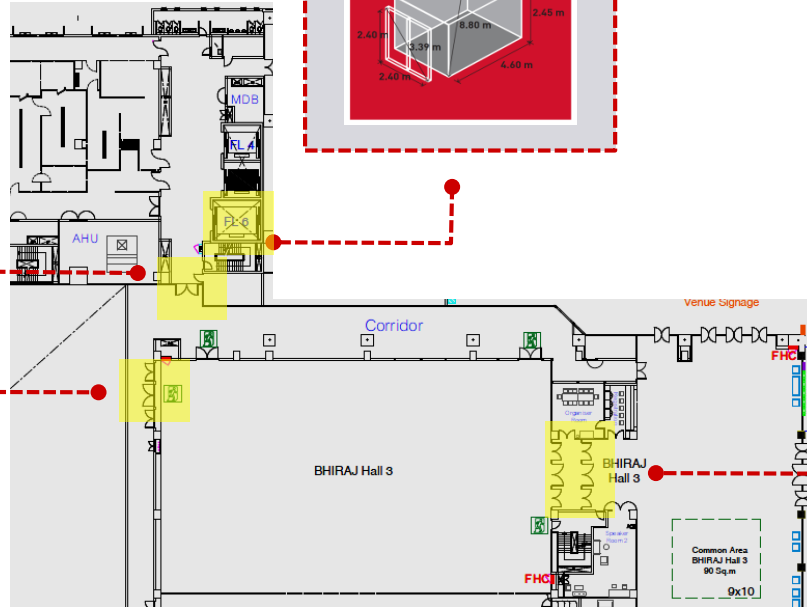

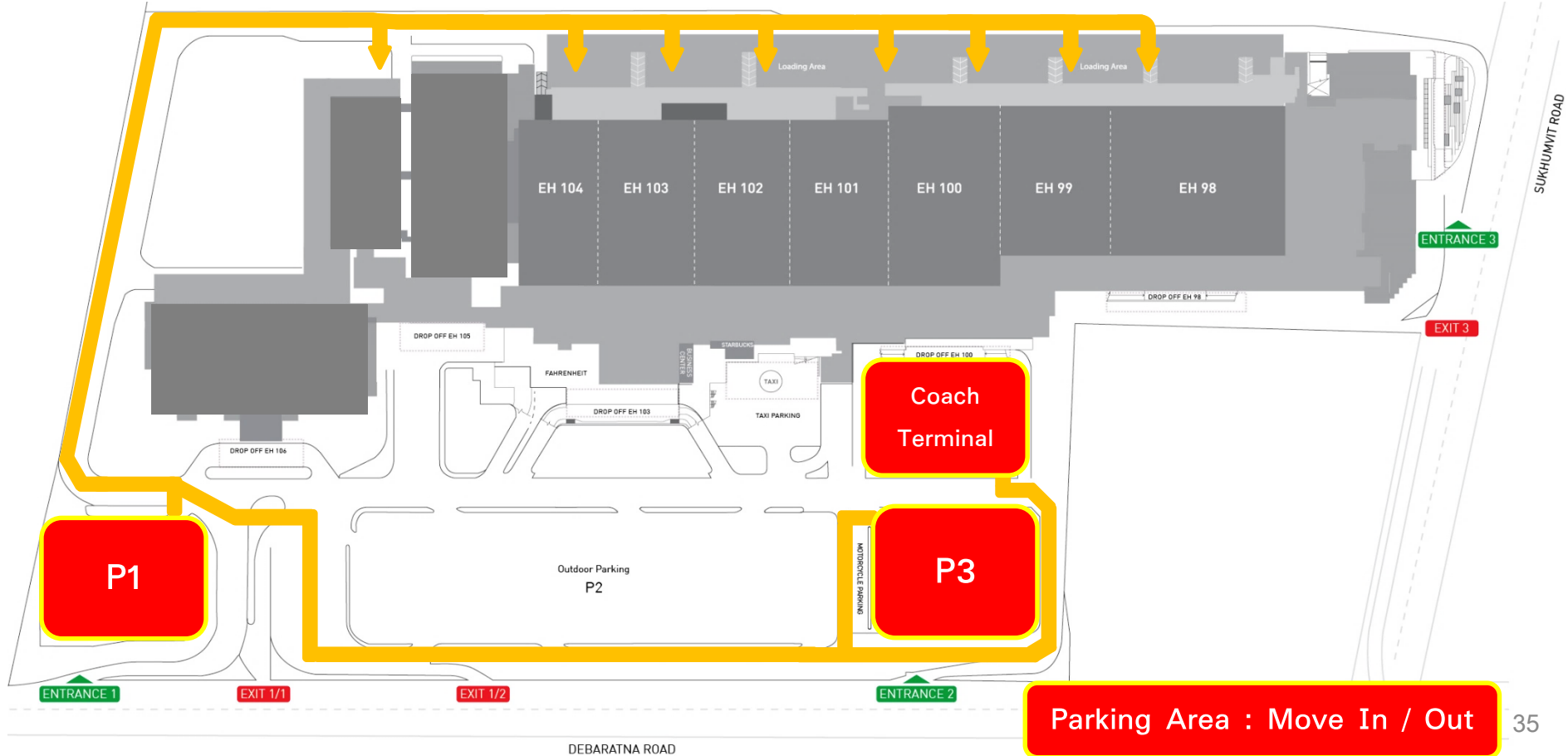

- Loading bays should not be used for parking. After loading or unloading is completed, vehicles must leave the area within limited time.
- Loading or unloading through the glass doors in front of the building is prohibited. The route to unload the product must be from the loading bay only.
- BITEC is not responsible for any damage, or loss of personal property before, during and after work.





LOADING BAY PARKING FEE

- Car/4-Wheel vehicles First 1 ½ hours free of charge
- More than 6-wheel vehicle. First 3 hours free of charge
- Succeeding hours 200 baht/hour
- In the event that the card is lost there will be a fine 1,000 Baht

(Payment can be made at the card accepting kiosk.)

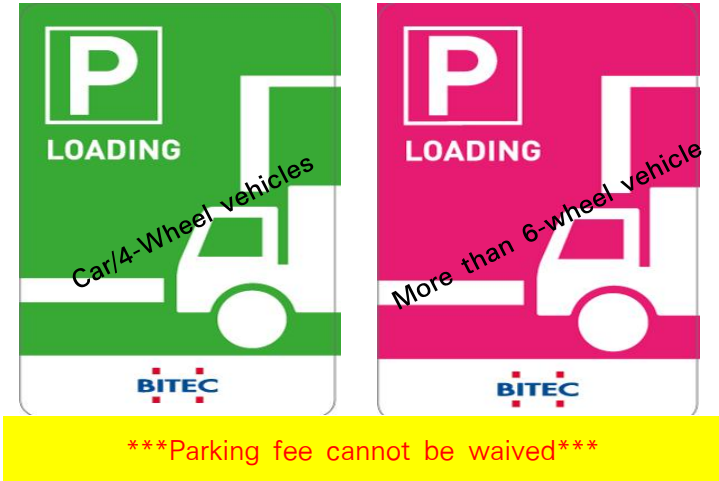



CONSTRUCTION &
SAFETY CONCERN



LOADING
RESTRICTION



TRAFFIC
ROUTING



PARKING
REGULATION

ROUTES GUIDE to MARSHALING YARD

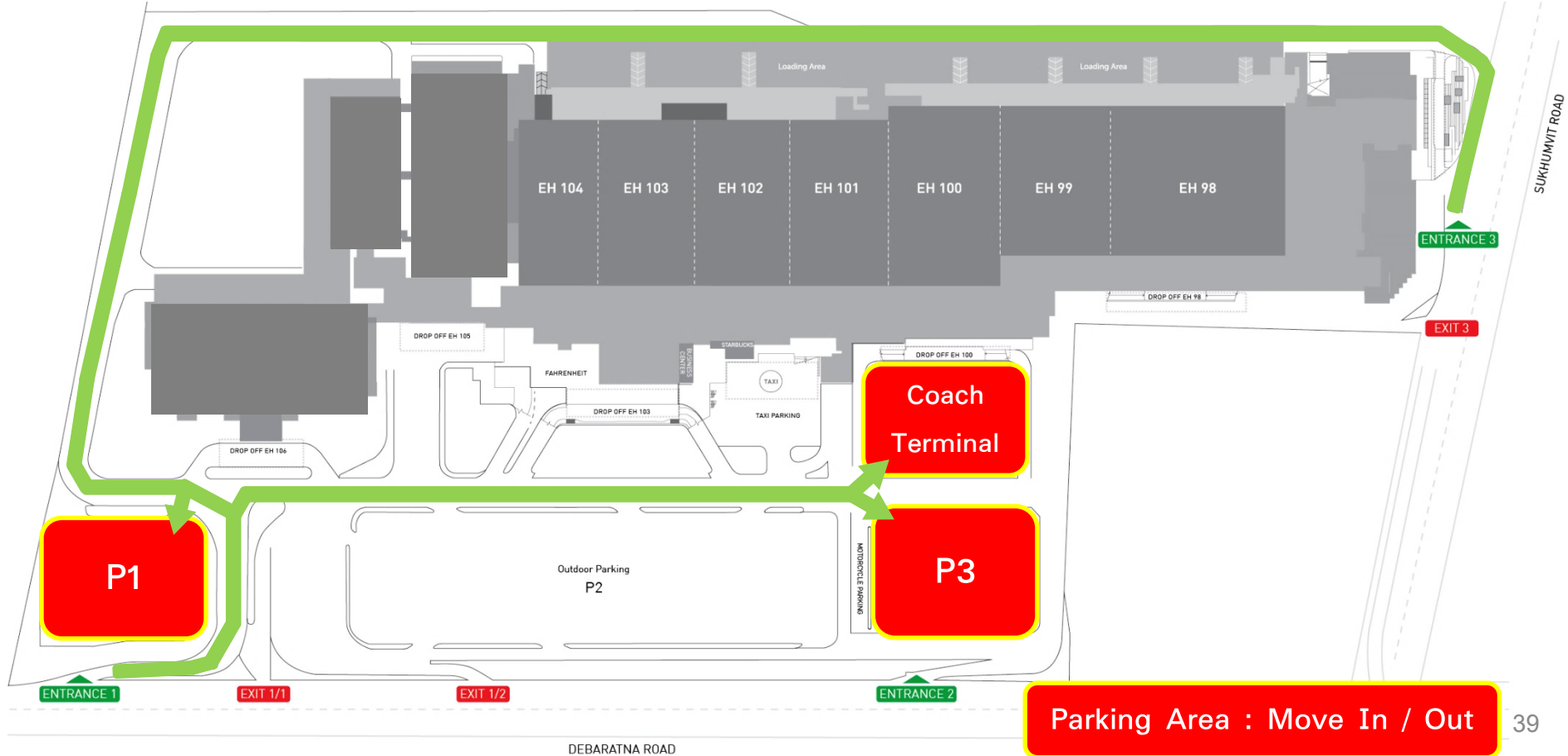

ROUTES GUIDE to INDOOR PARKING

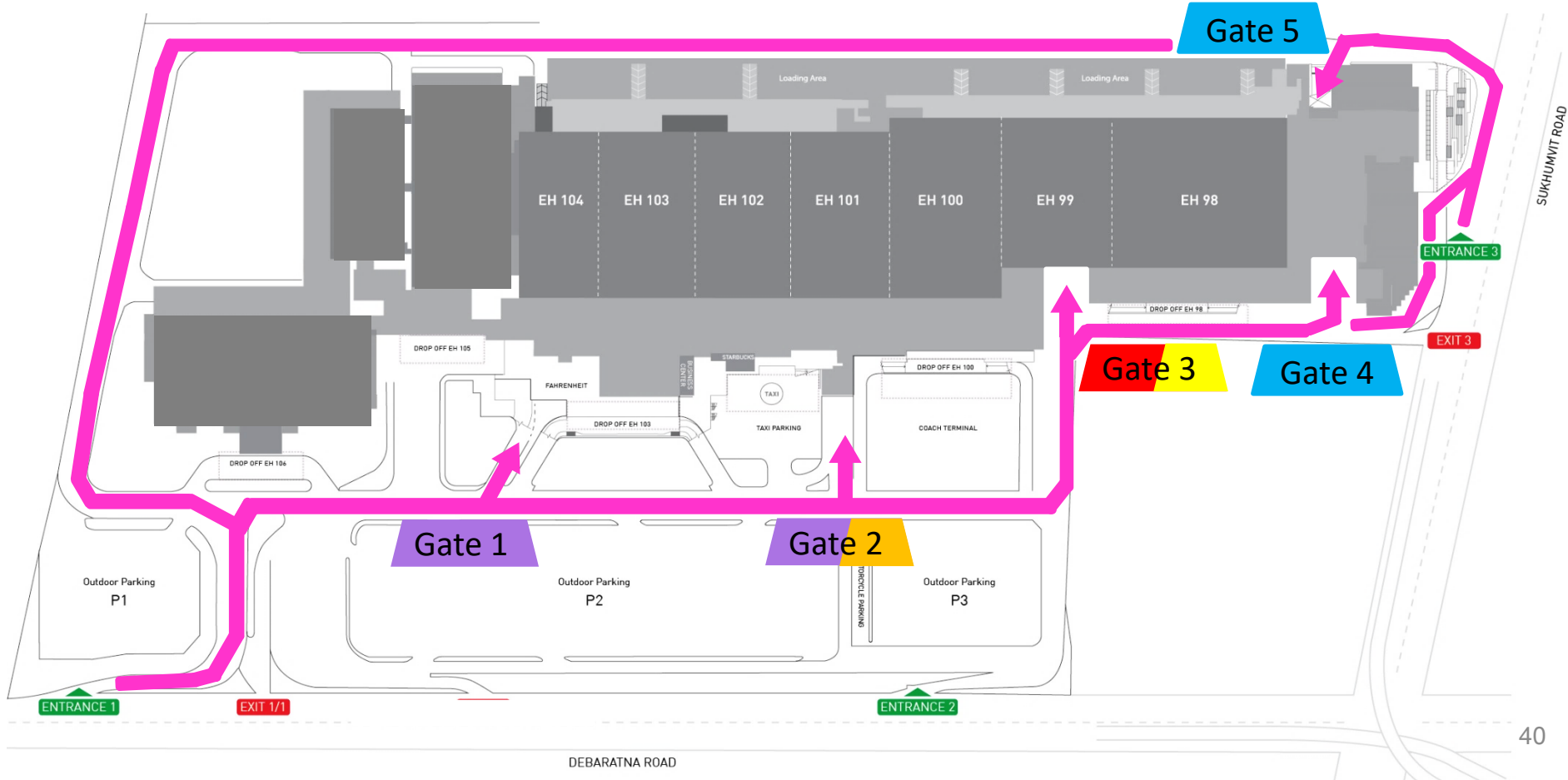

BASEMENT 1 INDOOR PARKING

ข้อกำหนดความสูงของรถลงใต้อาคาร

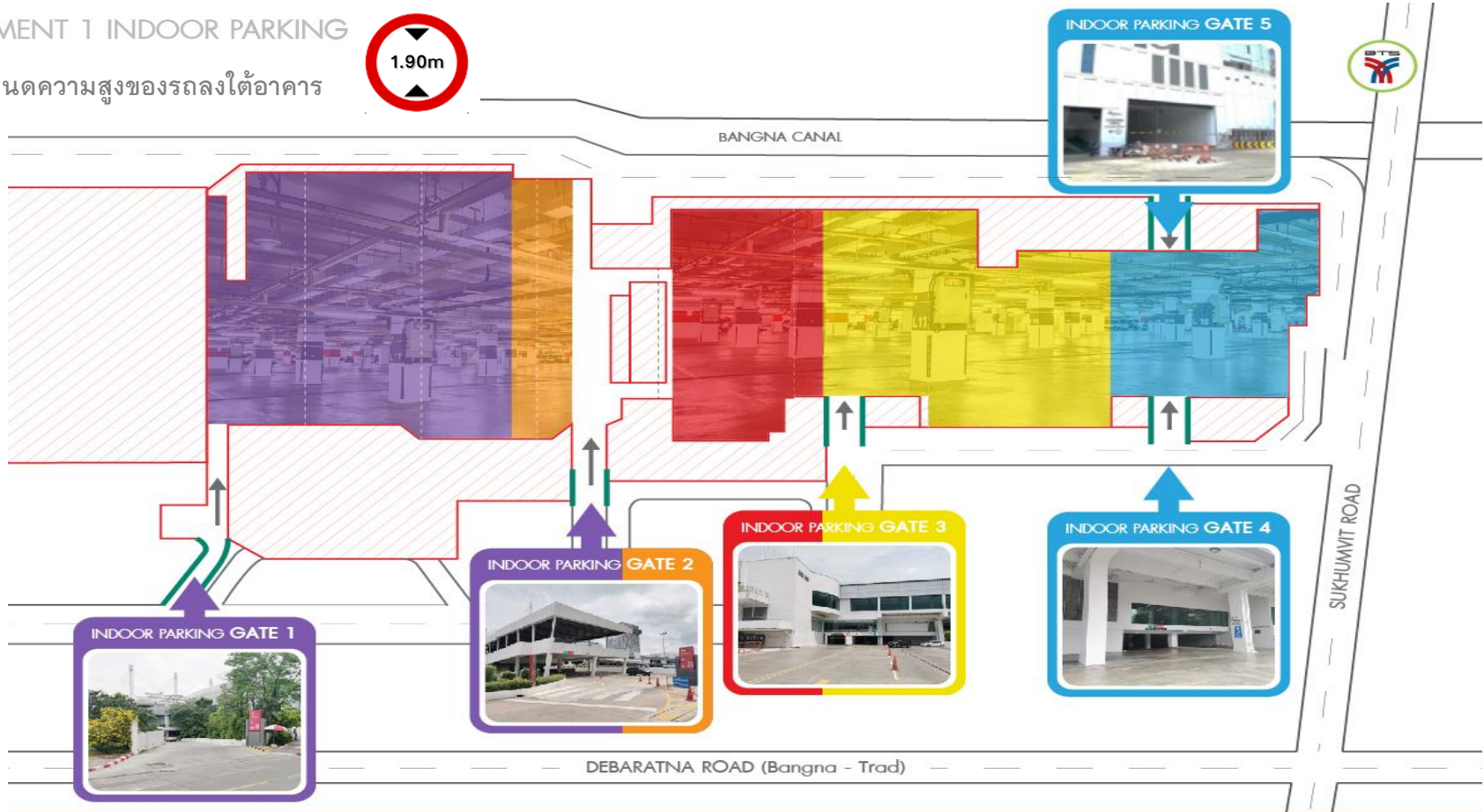

ROUTES GUIDE to MOTORCYCLE PARKING AREA

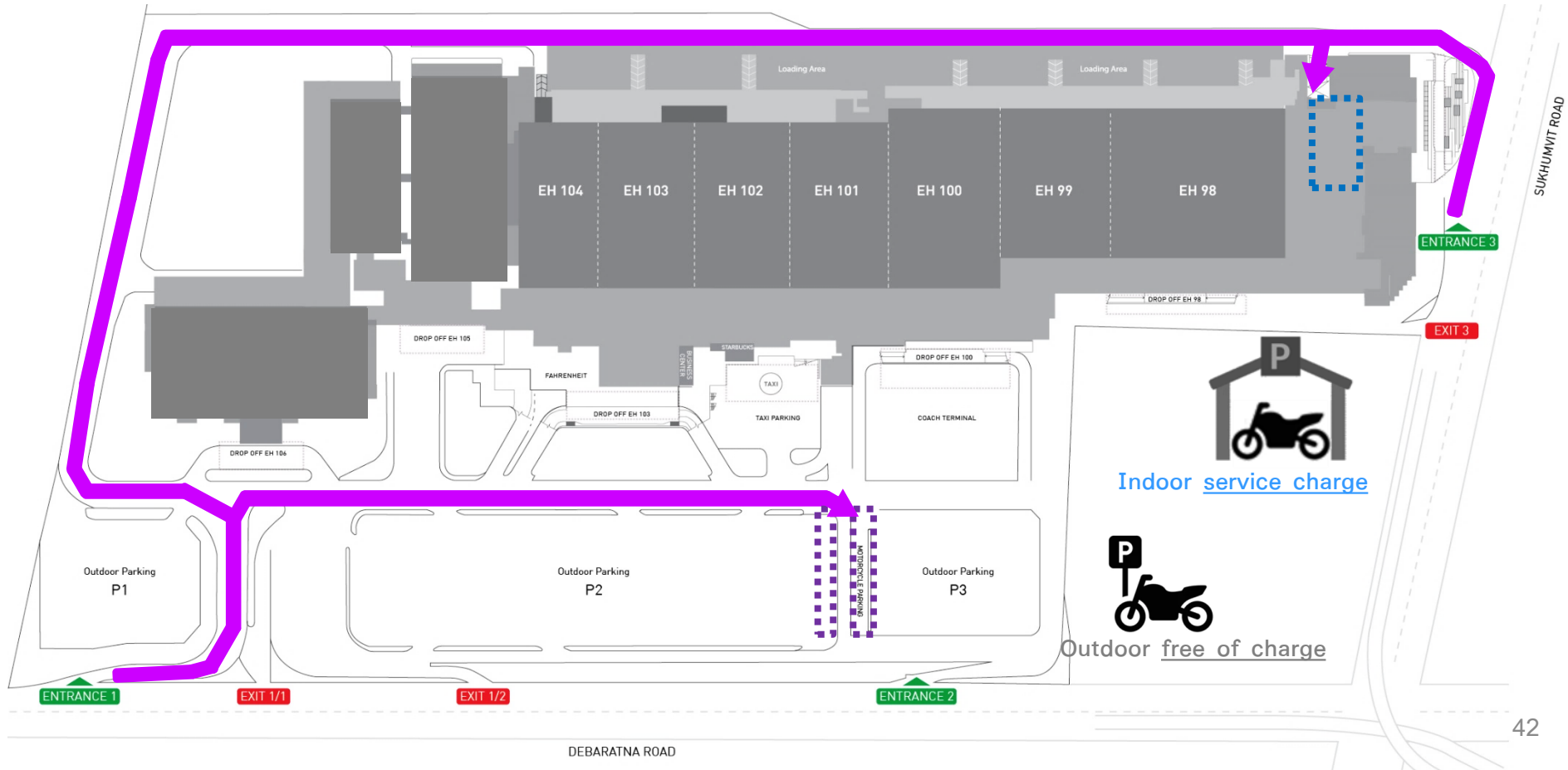



CONSTRUCTION &
SAFETY CONCERN



LOADING
RESTRICTION



TRAFFIC
ROUTING



PARKING
REGULATION



- **Red Card** for parking indoor free for the first 30 minutes
- **Dark Blue Card** for parking outdoor free for the first 3 hours
- Parking fees for both indoor and outdoor is 20 Baht/hour
- The parking lot open from 6 a.m. to midnight. Overnight parking is not allow.
- In case of overtime parking will be charge 100 Baht/hour.
- In the event that the card is lost there will be a fine 1,000 Baht (Payment can be made at the card accepting kiosk.)

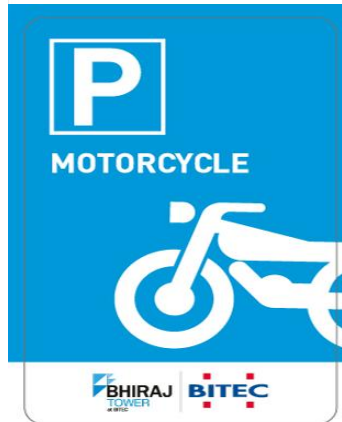

- **Car Blue Card** Basement Area is free for the first 30 minutes.
 - Succeeding hours 30 baht/hour (a fraction of an hour will be rounded up to 1 hour)
 - The parking lot open from 6 a.m. to midnight. Overnight parking is not allow.
 - In case of overnight parking will be charge 500 Baht/hour.
 - In the event that the card is lost there will be a fine 1,000 Baht (Payment can be made at the card accepting kiosk.)
-
- **Motorcycle Blue Card** Basement Area is free for the first 30 minutes.
 - Succeeding hours 10 baht/hour (a fraction of an hour will be rounded up to 1 hour)
 - The parking lot open from 6 a.m. to midnight. Overnight parking is not allow.
 - In case of overnight parking will be charge 300 Baht/hour.
 - In the event that the card is lost there will be a fine 1,000 Baht (Payment can be made at the card accepting kiosk.)

***Parking fee cannot be waived**



THANK YOU

YOUR **EVENT.** OUR **EXPERTISE.**

FOR MORE INFORMATION



BITEC B-Square



BITEC_Bsquare



BITEC_Bsquare